



## 360 ADJUSTABLE CENTER-LOAD BEAM CLAMP KIT, 1/2" ROD, 3 1/2" MAX PIPE

### CATALOG NUMBER

**3600050PL**



### FEATURES

Includes Series 26 Beam Clamp Extension Piece

### PRODUCT ATTRIBUTES

Material: Steel;Cast Iron

Finish: Plain

Rod Size: 1/2"

Pipe Size: 3 1/2" Max

MRI: 15/16"

Static Load: 1,130 lb

### ADDITIONAL PRODUCT DETAILS

Reduced hanger spacing is required when supporting 10" and 12" pipe.

Install in accordance with applicable code.

Part Number	A-2" B	A-3" B	A-4" B	A-5" B	A-6" B	A-7" B
3600037PL	5 5/16"	5 1/16"	4 15/16"	4 11/16"	5 1/8"	3 9/16"
3600050PL	5 5/16"	5 1/16"	4 15/16"	4 11/16"	5 1/8"	3 9/16"
3600062PL	5 1/2"	5 1/4"	5 1/8"	4 7/8"	5 5/16"	3 3/4"
3600075PL	5 1/2"	5 1/4"	5 1/8"	4 7/8"	5 5/16"	3 3/4"
3600087PL	5 3/4"	5 1/2"	5 3/8"	5 1/8"	5 9/16"	4"

## DIAGRAMS

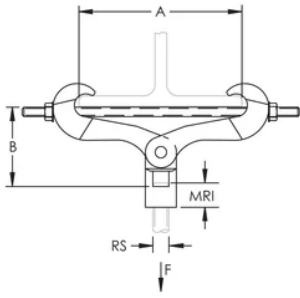

## WARNING

nVent products shall be installed and used only as indicated in nVent's product instruction sheets and training materials. Instruction sheets are available at [www.nvent.com](http://www.nvent.com) and from your nVent customer service representative. Improper installation, misuse, misapplication or other failure to completely follow nVent's instructions and warnings may cause product malfunction, property damage, serious bodily injury and death and/or void your warranty.

### North America

+1.800.753.9221  
Option 1 – Customer Care  
Option 2 – Technical Support

### Europe

Netherlands:  
+31 800-0200135  
France:  
+33 800 901 793

### Europe

Germany:  
800 1890272  
Other Countries:  
+31 13 5835404

### APAC

Shanghai:  
+ 86 21 2412 1618/19  
Sydney:  
+61 2 9751 8500



Our powerful portfolio of brands:  
nVent.com **CADDY ERICO HOFFMAN RAYCHEM SCHROFF**  
**TRACER**